

# QuickClean Bucket Waterer #540225



A) Insert threaded bolt (1.) through bottom of base.



B) Press triangle valve (7.) (with the smooth side of the triangular piece facing the outside) into red base (8.).



C) Place float valve (4.), which includes rubber valve (5.) into base of white pail. Flat rubber piece against the pail.



D) Set the large white plastic "diaphragm" (6.) onto the base of the pail (3.). Place it so the larger diameter side is against the pail.



E) Set the red base (8.) onto the white plastic "diaphragm" (6.).



F) Flip pail (3.) over so it rests on the red base (8.).



G) Place washer (2.) over the plastic bolt (9.).



H) Thread nut (1.) onto bolt (9.) and tighten.



I) Take the red plastic cap with 3 legs (10.) and firmly insert it onto the elevated plastic cone on the inside of the bucket.

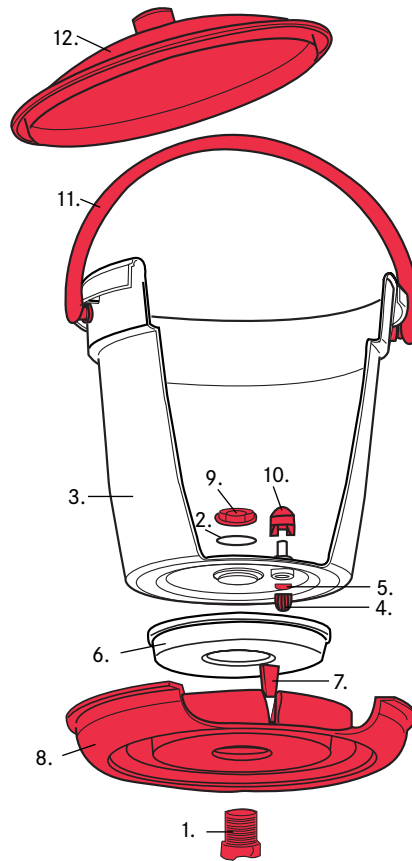

## Replacement Parts:

- 1. #54022501 Plastic bolt
- 2. #54022502 Rubber seal
- 3. #54022503 Bucket
- 4. #54022504 Flow valve
- 5. #54022505 Rubber valve
- 6. #54022506 Diaphragm/float
- 7. #54022507 Triangle valve
- 8. #54022508 Red plastic base
- 9. #54022509 Plastic nut
- 10. #54022510 Valve cover
- 11. #54022511 Handle
- 12. #54022512 Lid



J) Take the plastic handle (11.) and snap both pieces into the slots on the pail (3.). This will require reasonable pressure and force. There will be a definite "pop" sound when these have been properly installed.



K) Fill with water and place the red cover (12.) on top of the pail. Install by setting the waterer on level ground.



[www.premier1supplies.com](http://www.premier1supplies.com)

800-282-6631